



The Patchwork Pipeline

August 2008

Volume 24, Issue 8

2008 OFFICERS

| | |
|-------------------------------|------------------|
| President..... | Lisa Struthers |
| 1st VP, Programs '08..... | Anna Humphrey |
| Asst. 1st VP, Prog. '09..... | Barbara Staten |
| 2nd VP, Membership..... | Anita Knight |
| 3rd VP, Workshops 2008..... | Jane Ott |
| Asst. 3rd VP, Workshops 2009 | OPEN |
| 4th VP, Quilt Show '09..... | Lisa Green |
| 5th VP, Special Projects..... | Kathryn Kerr |
| Secretary..... | Katheryne Molina |
| Treasurer..... | Karen Elizondo |
| Parliamentarian..... | Sandra Floyd |
| Historian..... | Irene Ashe |
| Librarian..... | Karen Roberson |



2008 Committee Chairs

| | |
|--------------------------|------------------------------|
| Block of the Month..... | Pat Dunlp |
| Christmas Blocks..... | Barbara Garvey |
| Donation Quilt 2008..... | Anna Humphrey |
| Door Prizes:..... | Annette Kuder |
| Guild Retreat..... | Lois Garrett |
| Guild Trips..... | Janie DeStefano |
| Hospitality..... | Sherry Hughes |
| Mini Raffle..... | Barbara Petrie |
| Newsletter Editor..... | Katheryne Molina |
| Publicity..... | Jeanette Edmiston |
| Show & Tell..... | Sue Jenkins |
| Sunshine & Shadows..... | Barbara Sarria |
| Telephone | Janie McCall |
| Website..... | Lisa Dunlap & Tracy Williams |

If you are interested in filling one of the open positions, please contact President Lisa Struthers.

August 4, 2008 Program -

“Life is not a straight piece” Lecture/trunk show by: Debbie Bowles – Burnsville, MN.

www.mapleislandquilts.com info@mapleislandquilts.com

Debbie came to quilting via a lifetime of garment and craft sewing. Debbie’s approach to design, quilting and teaching draws on her experiences as an elementary school teacher, Cub Scout Den Mom and Jr. Hi church volunteer work as she leads each quilter to have fun while creating something that pleases them and is uniquely their own.

Through her pattern company, Maple Island Quilts and her books, *Cutting Curves from Straight Pieces* and *Dancing Quilts from Straight Pieces* (published by American Quilter’s Society) and *Quilts for the Dorm*, Debbie offers achievable, slightly non-traditional projects with enormous design possibilities for all skill levels. She calls her style controlled inventive.

Debbie teaches regularly at shops, guilds and events held throughout the US and internationally. She has appeared twice on Home & Garden TV-Simply Quilts (#622, 749), on PBS- M’Liss’s World of Quilts and Lifetime Real Women, American Quilter.

The Maple Island Quilts pattern line has 34 titles and is sold globally through the wholesale market to shops and the retail market at the web site, www.mapleislandquilts.com

Debbie’s quilts have been used in consumer and industry magazine advertisements and articles for many fabric companies. Her quilts travel worldwide to quilt shops. She frequently lectures for major fabric companies at industry shows.

We are networking/sharing this speaker with Bay Area, Woodlands and Kingwood Quilt Guilds. Hope to see you there!

Anna Humphrey – Programs-2008

Publications and Events

Maple Island Quilts – patterns for pieced quilt projects, 1998-current
Cutting Curves from Straight Pieces, AQS ,2001

Gallery Quilt in *Quilt Style*, Lucy Fazely, Running Press Books, 2002

Dancing Quilts from Straight Pieces, AQS ,2003

Gallery Quilt in *Batik & Beyond*, Jan Smiley, C&T, 2004

Quilt Project in *When Quilt Designers Think Small*, Creative Publishing Co., 2004

Quilts for the Dorm, Debbie Bowles, 2005

Quick Quilts magazine, Spotlight on Designers, issue 66, 2006

2006 Pilgrim/Roy Challenge-quilt on tour with exhibit

Alzheimer’s Art Quilt Initiative: Alzheimer’s: Forgetting Piece by Piece-quilt on tour, 2006-2009

www.AlzQuilts.org

BAQG Quilt Show '09 Proposal

As your 4th VP in charge of the Quilt Show, I would like to present the proposed plan for the "*Quilt Happening*" next year. After careful thought and long consideration, I choose not to re-create a traditional Quilt Show but I would like to propose that we combine a small Quilt Show with a BIG *25th Anniversary Celebration* which we will celebrate in 2009.

I have talked with my Bee (the magnificent Material Girls) and once again they have agreed to help me with this huge responsibility. We will split the committee into quarters as they will become co-chairs with me as your chairperson. With the help of Connie Litter, I have been in contact with the Goose Creek Country Club to be the venue for our Show/Celebration. I am excited to announce that we have booked a tentative date of Saturday, May 2nd, 2009. As presented to the board at the July board meeting and with their unanimous acceptance, I hope you too will support this proposal.

While these are just preliminary plans with more details to follow, I envision a display of quilts, vintage and new, from our members as well as the following:

- o *25 years...BAQG looks back while looking forward*
- o *A History Display*
- o *An elegant Luncheon*
- o *Community Service Display*
- o *Donation Quilt Drawing*
- o *Door Prizes*
- o *Raffle Baskets*
- o *Silent & Live Auction*

And a few surprises

We feel that if we eliminate a traditional show of entered judged quilts, we can also eliminate a lot of extra work and expense. We know this will still take a great deal of planning and securing the help of another great committee but, with the membership's help we are confident we can make this a wonderful Quilt Show Celebration. We feel this can be a successful fundraiser as well, minus 18 months of planning and a team of 100 working tirelessly for 4 straight days.

All members are invited to display a quilt and we can assure everyone that loans us a quilt for this occasion that extra steps will be taken to provide great care of your heirloom. We will place as many quilts on display as space allows and they can be displayed in many ways rather than just being hung the traditional way. There would still be a check in-check out system in place for quilt security.

I also have a preliminary budget I will share with you at the next guild meeting. Of course, we have some adjustments to make so I will prepare and present a final budget at the September guild meeting with it being published in the newsletter upon approval.

We think this is a great alternative to the huge undertaking of another big traditional quilt show. Let's all think positive and be sure you show your support by asking how you can help!

Sincerely,
Lisa Green

4th VP Quilt Show Chair, 2008 / 2009

BAQG - ACCOUNT TRANSACTIONS FOR 2008

| CK# | DATE | PAYEE | CATEGORY | AMOUNT | RUNNING BALANCE |
|--------------------------------|---------|-----------------------|---------------------------------|-----------|-----------------|
| | | | Opening Balance as of 1/1/08 | | 14,892.73 |
| <u>Month Ending 1/31/08</u> | | | | | |
| 2138 | 1/06/08 | Lisa Green | BAQG Dec 07 Newsletter | -77.14 | 14,815.59 |
| 2139 | 1/06/08 | Connie Litteer | BAQG 2007 Quilt Show | -35.30 | 14,780.29 |
| 2140 | 1/07/08 | Tracy Williams | BAQG Jan 08 Newsletter Printing | -8.39 | 14,771.90 |
| 2141 | 1/07/08 | Karen Kay Buckley | Workshop | 1,331.67 | 13,440.23 |
| <u>Month Ending 2/29/08</u> | | | | | |
| | 2/04/08 | Deposit | | 2,202.00 | 15,642.23 |
| | | Membership | 1,065.00 | | |
| | | Merchandise | 18.00 | | |
| | | Mini Raffle | 61.00 | | |
| | | Advertising | 160.00 | | |
| | | K. K. Buckley WS | 898.00 | | |
| 2142 | 2/24/08 | Anita Knight | Supplies | -84.00 | 15,558.23 |
| 2143 | 2/24/08 | Anna Humphrey | Programs | 250.49 | 15,307.74 |
| <u>Month Ending 3/31/08</u> | | | | | |
| 2144 | 3/08/08 | Irene Ashe | 2008 Scrapbook | -14.28 | 15,293.46 |
| 2145 | 3/08/08 | Barbara Garvey | Christmas Blocks | -110.75 | 15,182.71 |
| 2146 | 3/08/08 | Katheryne Molina | Newsletter & Stamps | -76.46 | 15,106.25 |
| 2147 | 3/08/08 | Anna Humphrey | Programs | -108.83 | 14,997.42 |
| 2148 | 3/08/08 | Miller Quilts, Inc. | Workshop | 1,376.43 | 13,620.99 |
| <u>Month Ending 4/30/08</u> | | | | | |
| | 4/07/08 | Deposit | | 1,255.00 | 14,875.99 |
| | | Membership | 726.00 | | |
| | | Merchandise | 64.00 | | |
| | | Workshop | 455.00 | | |
| | | Advertising | 10.00 | | |
| 2149 | 4/06/08 | Lynn Roddy Brown | April Lecture/Trunk Show | -234.92 | 14,641.07 |
| 2150 | 4/07/08 | Katheryne Molina | Newsletter & Stamps | -119.55 | 14,521.52 |
| 2151 | 4/07/08 | Anita Knight | Yearbook & Postage | -119.68 | 14,401.84 |
| 2152 | 4/07/08 | Irene Ashe | Photo Paper | -3.60 | 14,398.24 |
| 2153 | 4/07/08 | Lisa Green | Website Expenses | -35.94 | 14,362.30 |
| 2154 | 4/07/08 | Judy Moody | Quilting Donation Quilt | -95.31 | 14,266.99 |
| 2155 | 4/07/08 | St. Mark's Met.Church | Rent | -1,020.00 | 13,246.99 |
| <u>Month Ending in 5/30/08</u> | | | | | |
| | 5/05/08 | Deposit | | 783.00 | 14,029.99 |
| | | Membership | 60.00 | | |
| | | Donation Tickets | 539.00 | | |
| | | Merchandise | 35.00 | | |
| | | Mini-Raffle | 149.00 | | |
| | 5/30/08 | Deposit | | 457.00 | 14,486.99 |
| | | 2007 Retreat | 161.00 | | |
| | | Donation Tickets | 271.00 | | |
| | | Merchandise | 25.00 | | |
| 2156 | 5/05/08 | Anna Humphrey | Thank you Gifts | -33.59 | 14,453.40 |
| 2157 | 5/05/08 | Katheryne Molina | Newsletter | -61.58 | 14,391.82 |
| 2158 | 5/05/08 | Janette Lott | Catalog for Members | -39.92 | 14,351.90 |

Continued page 4

Continued from page 3

| CK# | DATE | PAYEE | CATEGORY | AMOUNT | RUNNING BALANCE |
|-----------------------------|---------|------------------|------------------------|-----------|-----------------|
| <u>Month Ending 6/30/08</u> | | | | | |
| 2159 | 6/02/08 | Karen Elizondo | Post Office Box Rental | -54.00 | 14,297.90 |
| 2160 | 6/02/08 | Irene Ashe | Scrapbooking | -62.02 | 14,235.88 |
| 2161 | 6/02/08 | Anna Humphrey | Programs | -141.16 | 14,094.72 |
| 2162 | 6/02/08 | Marcia Kaylakie | Programs | -417.15 | 13,677.57 |
| <u>Month Ending 7/31/08</u> | | | | | |
| 2163 | 7/07/08 | Marcia Kaylakie | Library | -43.25 | 13,634.32 |
| 2164 | 7/07/08 | Katheryne Molina | Newsletter | -132.46 | 13,501.86 |
| 2165 | 7/07/08 | Cynthia England | Programs | -376.88 | 13,124.98 |
| 2166 | 7/07/08 | Lois Garrett | Guild Retreat | -2,520.00 | 10,604.98 |

MEMBERSHIP - July Meeting

There were 68 members present at the July meeting. We had 3 visitors and 4 new members. Pat Kell won the name tag drawing. Wear your name tag to the meeting and sign up for a fat quarter. I have Guild tote bags in four colors for \$10.00 each, lighted rotary cutters for \$10.00 and Travel mugs for \$5.00. They are available at the sign in table. GOOD NEWS, our Guild lapel pins are here!! We will have them at the August meeting. They are \$5.00 each -- at the sign in table! Don't forget to turn in your tickets and money for the donation raffle quilt --at the sign in table. **Anita Knight**

Painted Pony 'n Quilts

Visit us online: www.ppnq.com

Contact us: ppnqstaff@ppnq.com or 281-471-5735

SIGN UP TODAY!

Baltimore Baskets class with award-winner Georgann Wrinkle

Continuing lessons in the fine art of Baltimore Album quilting.

Prerequisite: Confident appliqué beginner to advanced skills.

Thurs., Aug. 28, Sept. 25, & Nov. 6 (9:30am-noon)

Cotton Theory I class: Learn "quilt first, then assemble" technique!

Sat., Aug. 23 (9:30am-3:30pm)

Holiday Chorus "Block of the Season" 4-month Project

Beautiful holiday project - not just for Christmas! **In Progress!**

Optional Holiday Clubhouse - 2nd Saturday meetings for 4 months at 10am.

Kick off meeting - Sat., July 12 @ 10:00am

NEW Notions! Sewline Fabric Pencil - fine line, erase or wash out; Sewline Fabric Glue Pen - holds fabric easier than pins - refills available, water soluble; Half Square Triangle Tiger Tape; The Quilter's Boot - for mitered binding with no bulk; Strip Tube Ruler;

Fat Cat Ruler by Darlene Zimmerman.

Fabrics back in stock! Exclusive bluebonnet batik, Wizard of Oz, Mark Twain.

Fun Halloween and beautiful Christmas collections have arrived!

Good stuff goes fast!!



1015 S. Broadway, La Porte, TX 77571

M-F 10am-5pm; Sat. 10am-4pm

AUGUST BIRTHDAYS

- Joanne Webb 08/01
- Connie Litteer 08/06
- Kathy Thompson 08/09
- Linda McPike 08/10
- Kathy Solka 08/17
- Eleanor Mainer 08/19
- Willie Kling 08/22
- Ann Crawford 08/26
- Pat Dunlop 08/30
- Sandra Floyd 08/30

Happy Birthday from all your friends at Baytown Area Quilt Guild.

Katheryne Molina

SHOW AND TELL

By Sue Jenkins

- Joanne Webb - Azleway and baby quilts
- Mary Benham - Machine embroidery towel and Pillowcases
- Marian Woods - Little Brown Bird
- Shirley Smith - Blocks
- Patsy Eskew - Double wedding ring for grandson
- Lisa Green - Hydrangea quilt
- Barbara Staten - Two quilts
- Clara Perry - Two quilts
- Anita Knight - Two lap size quilts
- Kathy Thompson - One charm quilt; two bags
- Lisa Struthers - One Azleway quilt
- Anna Humphrey - Graduation quilt

**BAQG HOSPITALITY
AUGUST HOSTESSES**

- CAMEO BROWN
- LISA DUNLAP
- SANDRA FLOYD
- ANITA WESTERMAN
- JOYCE COX
- WILLIE KLING
- ANNA HUMPHREY
- PAT DUNLOP
- JOANNE WEBB



The meeting will be on August 4, 2008. Ice is available at the church. Please ask the ladies to clean the kitchen and the meeting room afterward.

Sherry Hughes

The Quilt Room



A Quilt Shop and Fabric Creations Store

11515 FM 1960 Suite E
Huffman, TX 77336

(We are located next to Family Dollar on FM 1960 in Huffman)

281-324-9018

Hours:

10am - 6:00pm Monday thru Friday
10am - 3:00pm Saturday



Bertin's Vacuum an& Sewing

We are ready to serve you
Estamos listos para servirle



Gonzalez Bertin
1011 Patsy at Alexander
Baytown, Texas 77520
Office: 281-427-5522



Appliance Repair
Free House Calls
Sewing Machines
20% Off



BOM SEPTEMBER 2008

A, B, C, D, E, F is brown print

G, H, I, J is small checks (multi-color)

If you don't have this choice of fabric use what you have, this way you can get rid of some of your small scraps

Pat Dunlop

| USED FOR | SHAPE/COLOR | NUMBER TO CUT | 12" |
|----------|-------------|---------------|----------|
| A | | 2 | 3 X 12½ |
| B | | 1 | 2½ X 3 |
| C | | 1 | 1¼ |
| D | | 1 | 1¾ X 3 |
| E | | 1 | 3 |
| F | | 1 | 2¼ X 3 |
| G | | 1 | 7½ X 10½ |
| H | | 1 | 2½ |
| I | | 1 | 1 |
| J | | 2 | 1¼ X 3 |

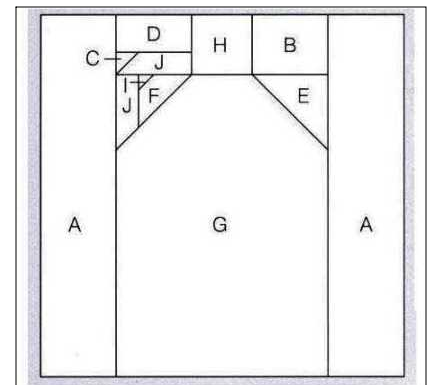
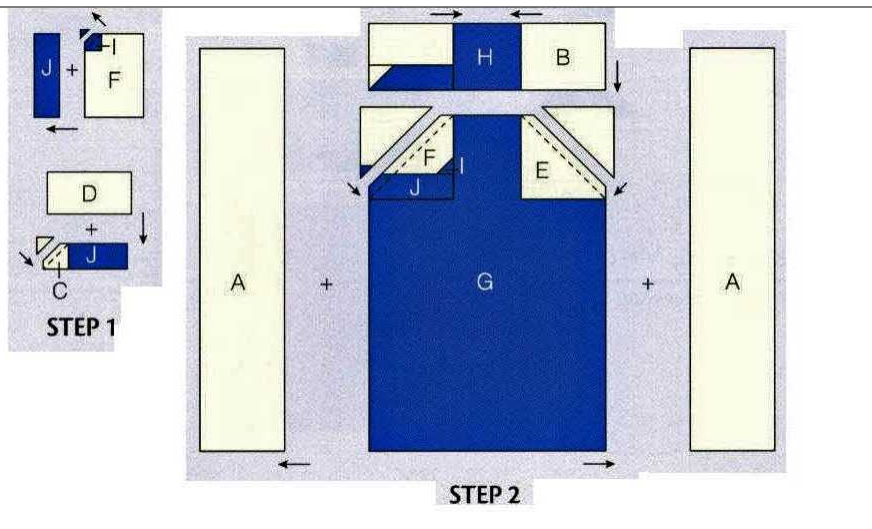

GENERAL MEETING MINUTES - July 7, 2008

President Lisa Struthers called the meeting to order. Anna Humphrey introduced our speaker, Cynthia England, who brought a program highlighting various ways to use fabrics in her picture quilts.

Lisa thanked those on this month's hospitality committee. She wished a happy birthday to the July birthdays.

Barbara Staten passed out a survey to learn what the members wished in the way of programs and workshops for next year.

Sunshine & Shadow chair, Barbara Sarria read a thank you note for a sympathy card.

Kathryn Kerr invited us to a workshop to make quilts for Azleway. It will be held this coming Saturday from 9:00 -12:00 at the First Methodist Church in LaPorte.

Lois Garrett gave a report on the retreat and showed the quilt created for the auction.

Pat Dunlop discussed the block of the month. Anita Knight won this month's blocks.

Show and Tell was held

The mini-affle was held. Door prizes were won by Sherry Hughes and Pat Dunlop. Pat Kell won the nametag drawing.

The meeting adjourned.

Respectfully submitted,

Irene Ashe, secretary pro-tem

Letter to the Editor -

Something that needs to be said.....

Talking or having your cell phone on while our speaker, president or ladies giving reports to the entire Guild is probably the most annoying and rude behavior to the speaker, people giving their reports and entire guild members in attendance.

Members need to extend good manners while attending a Guild meeting.

Everyone is important to the Guild membership and all too often I've heard from our speakers and guild members alike who couldn't believe the distraction of groups talking, and believe me, your voice carries even at a whisper from the back of the room. No one intends to be rude, we just get so carried away with sharing some wonderful quilting news, so let's remember to turn off those cell phones or put them on silent and come early for visiting during the social time at 6:30 p. m.

Anna Humphrey-Programs-2008

OCTOBER 6TH - SILENT AUCTION

Dear members, in October we will be having a Silent Auction to raise money for next years programs. If you have any kits, sets of blocks, quilt tops, completed quilts or wall hangings, fabric, books, patterns, notions, thread, tools or anything pertaining to quilting that you might deem useful and no longer want you may bring them and turn them in so we can begin to organize them for the Auction. Please let me know if you are able to help with the Auction in October. Thanks. ** I will have a large suitcase sitting by the table before you come into the meeting room. Please sign and list the articles that you brought if you wish. Remember the success of the auction depends on each member to help as they can. **** The quilt top made at Cho-Yeh is awesome and will be a wonderful auction quilt. Who will be the lucky bidder? I am receiving many nice items, but we need many more. Karen Roberson, our librarian, has agreed to be in charge of the books and magazine table at the auction, so please bring these items to her.**

Anna Humphrey - Programs - 2008



Bluebonnet Quilts

10% off Coupon Code: TexasGuild

Phone: 713-481-5314
Toll Free: 866-529-1694
AskMe@BluebonnetQuilts.Com
BluebonnetQuilts.Com



KATHY McLEAN
Machine Quilter

Sunshine Quilt Shop

Long Arm Machine Quilting

Award Winning
Designer & Quilter

281-467-2793
By Appointment

Quilting with a Friend will keep you in Stitches



CELEBRATING
OVER
20 YEARS
OF QUILTING

501C7
ORGANIZATION/
SOCIAL CLUB

- Meetings are held the 1st Monday of each month at St. Mark's United Methodist Church located at 3811 N. Main Street, Baytown, TX.
- Join us on Monday, August 4th. Refreshments will be served promptly at 6:30 p.m. followed by the program and meeting at 7 p.m.
- *All* Board Members are *required* to meet promptly at 6:00 prior to the General Meeting. The meeting room is the classroom on the left before entering the Activity Center at St. Mark's UMC.

Things to bring in August:

- My Name Tag
- Block of the Month
- President's Blocks
- Library Books
- Show & Tell Items
- A few friends
- Dues

**CHRISTMAS BLOCKS
DUE OCTOBER !!**

We're On The Web!
<http://www.baytownareaquiltguild.com>

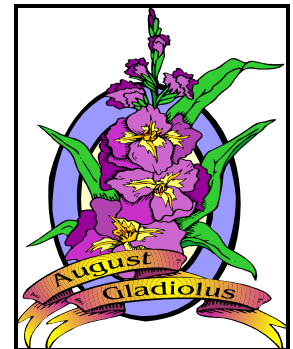

Place
stamp
here

**BAYTOWN AREA
QUILT GUILD**

P.O. Box 1531

Baytown, Texas 77522

Phone: 281-479-2421

E-mail:

lisastruthersatyahoodotcom

Change Service Requested

To:

